



Hako
Clean ahead

Assembly manual

Cleanserv VL140 L / 24V (6509) for Sweepmaster B980 R/RH

Introduction

Introduction

Have the mounting action described in the present assembly instructions executed in a local Hako service centre or workshop.

The qualified personnel required for these works is available in the above mentioned workshops only.

Proper Use

The vacuum cleaner mounting kit is to be considered part of accessories which must be exclusively used for the Sweepmaster B980 R/RH machines.

The vacuum cleaner has been exclusively designed for collecting dry and moist matter from floor surfaces in e.g. factories, storage buildings, parking ground and pedestrian areas.

Safety provisions

Comply with the general safety provisions/regulations from the applicable operating instructions of the corresponding machines.

This present mounting instructions are to be used only in combination with the previously mentioned operating instructions.

Before mounting the vacuum cleaner, switch the motors off.

Important:

This unit has not been designed for collection of hazardous dusts.

This unit has been constructed for dry cleaning and not for outdoor use and storage and must not be used or stored under humid conditions.

Do not collect combustible liquids or dusts.

The machine has not been designed for collecting dusts which are detrimental to health.

After mounting, proceed to a functional check and a safety test according to the relevant provisions.

Before returning the machine, execute a functional and operation test of the machine.

Please be advised explicitly that we cannot accept any legal issues out of the contents of this manual. If repair work has to be performed make sure that only genuine spare parts are used; only genuine spare parts may guarantee a dependable machine and will make sure that your rights under current warranty are not affected.

We reserve the right for technical improvement.

Valid as of: April 2014

Hako GmbH
D-23843 Bad Oldesloe
Hamburger Str. 209-239
Telefon +49 4531 806-0

Table of Contents

Table of Contents

Introduction	2
Proper Use	2
Safety provisions	2
1 Mount vacuum cleaner	4
1.1 Parts set	4
1.2 Prepare machine	5
1.3 Mount holder for cleaner tube	6
1.4 Mount cleaner holder	7
1.5 Lay harness	8
1.6 Take machine into operation	10
1.6.1 Vacuum cleaner operation	10
1.6.2 Clean vacuum cleaner	10

Parts set

1 Mount vacuum cleaner

1.1 Parts set

The set comprises the following:

- 24 V cleaner (5m cable, stranded) (Fig. 1/1)

- Cleaner holder (Fig. 1/2) with:

- 2x M8x30 flat head screw
- 2x washer, Ø 8.4
- 2x M8 nut
- 2x SW13 cap
- 3x 10x14 cable sleeve
- 2x 5x14 fladflat pan head screw
- 1x Edge protection

- Holder for cleaner tube (Fig. 1/3) with:

- 4x M6x20 lens flange screw
- 4x washer, Ø 6.4
- 4x M6 nut
- 4x M3x10 lens head screw
- 4x M3 nut
- 8x washer, Ø 3.2
- 2x tool holder
- 2x holder

- Parts for electric connection:
- 30A, F10 (x1) fuse link
- W16 harness comprising:
 - 1x 3-pole terminal strip
 - 1x ST 2.9x16 sheet metal screw
- or for older vehicles with:
 - 1x M3x16 pan head screw
 - 1x washer, Ø 3.2
 - 1x M3 nut
- Cable guide for vacuum cleaner:
 - 1x cable Sleeve
 - 2x TC141 screwed base
 - 1x 3.5x9 sheet metal screw
 - 10x cable bind
- Strain relief with angle:
 - 1x PG13.5 screwed cable gland
 - 1x Angle with lift-up dumping:
 - 2x M10x25 screw (49Nm)
 - without lift-up dumping:
 - 2x M8x18 screw
 - 2x M8 nut
 - 2x washer, Ø 8.4

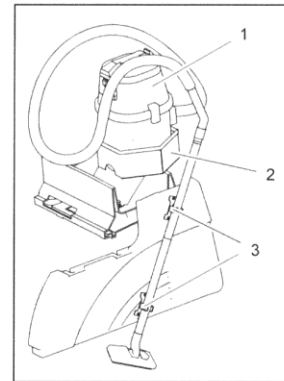

Fig. 1 Parts set

4

52014

Prepare machine

1.2 Prepare machine

1. Park machine on level ground and secure by engaging the parking brake.
2. Switch off machine and pull key.
3. Tilt up seat console (Fig. 2/1).
4. Disconnect battery plug (Fig. 2/2).
5. Remove battery from machine.



If the machine is equipped with a tray-type battery, use a lifting device for removal.

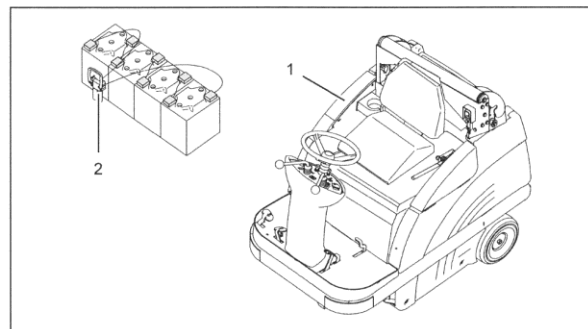

Fig. 2 Prepare machine

52014

Mount holder for cleaner tube

1.3 Mount holder for cleaner tube

1. Tilt seat console upwards and remove filter cover from the frame.
2. Loosen screws at the inside of the left-hand fairing (Fig. 3/1).
3. Lightly tip fairing to the outside and remove.
4. Bore two holes ($\varnothing 7$ mm) acc. to drawing (Fig. 3/2) from the fairing inside through both walls.
5. Place both holders (Fig. 3/3) at the outside wall, align and bore holes.
6. Re-work all 4 holes at the inside wall from $\varnothing 7$ mm to min. $\varnothing 20$ mm to allow fixing of the holder.
7. Mount upper and lower holder by means of screws, nuts and washers.

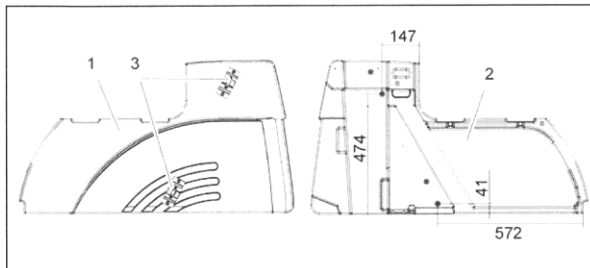

Fig. 3 Mount holder for cleaner tube

6

52014

Mount cleaner holder

1.4 Mount cleaner holder

1. Bore through the cone-shape deepening of the filter cover (Fig. 4/1) from below with $\varnothing 9$ mm.
2. Place cleaner holder (Fig. 4/2) and align to boreholes (Fig. 4/3). Mark the rear two holes (Fig. 4/4) and bore with $\varnothing 2.5$ mm.
3. Fasten cleaner holder by means of screws, washers, nuts, cable sleeves and caps at the filter cover.

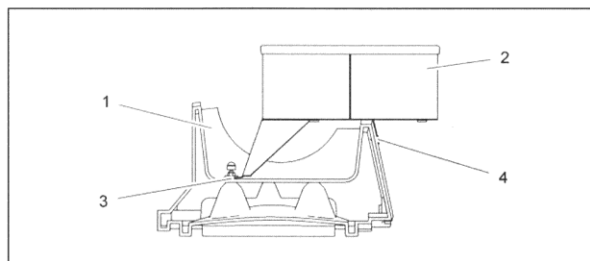

Fig. 4 Mount cleaner holder

52014

Lay harness

1.5 Lay harness

1. With lift-up dumping:

Mount angle (Abb. 5/2) to the lift-up dumping stand (Abb. 5/3) with 2x M10x25 screw (49 Nm).

Without lift-up dumping:

Mount angle (Abb. 5/2) to stand (Abb. 5/4) with 2x M8x18 screw, 2x M8 nut and 4x Ø 8,4 washer.

2. Mount strain relief (Fig. 5/1) to angle (Fig. 5/2) and cable sleeve (Fig. 5/5) to the stand.

3. Lay cleaner cable through the strain relief device and cable sleeve and fix with cable binds.



Provide for sufficient clearance in the area of the belt.

4. Mount screwed base to frame (Fig. 5/6) with sheet metal screws and fasten the cable at the base.

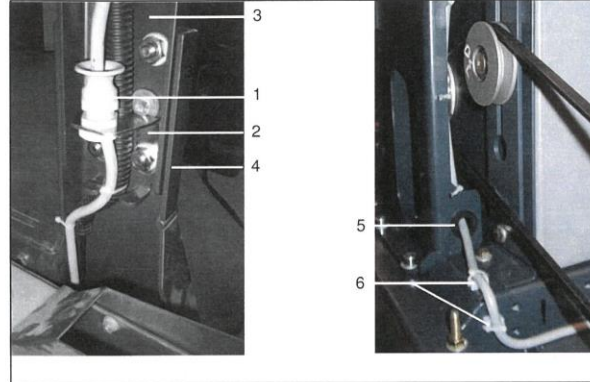

Fig. 5 Lay harness

Lay harness

Continue - Lay harness

5. Fix cable in chassis at the engine line (Fig. 6/1) with cable binds.

6. Connect cable and terminal strip of W16 harness (Fig. 6/2).

7. Insert (30A) blade-type fuse in F10 fusebox (Fig. 6/3).

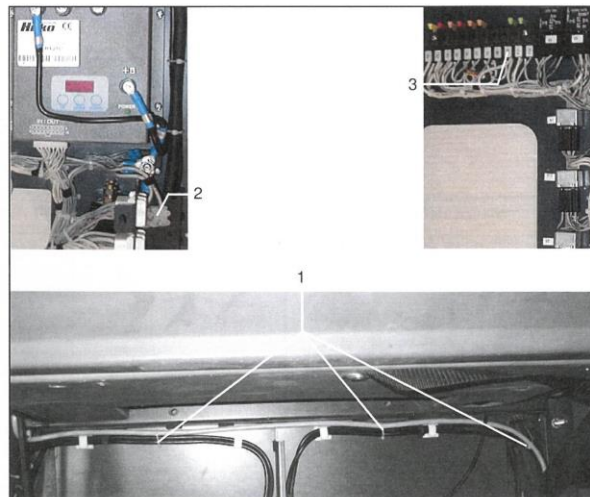

Fig. 6

Take machine into operation

1.6 Take machine into operation

After cleaner has been mounted according to the instructions, proceed as follows:

1. Insert batteries.
2. Connect battery plug, see operating instructions.
3. Turn on machine by key switch.
4. Proceed to functional and working test of the vacuum cleaner and the machine.

1.6.1 Vacuum cleaner operation

Use the main switch (Fig. 7/1) to turn the vacuum cleaner on and off.

1.6.2 Clean vacuum cleaner

1. Open the locks of the suction unit (Fig. 7/2) and take off suction unit.
2. Remove and clean filter.
3. Clean hopper and wipe dry.
4. Clean floater (situated in the filter basket).
5. Proceed in inverse order for assembling the vacuum cleaner.

Main switch (Fig. 7/1)
Suction unit (Fig. 7/2)
Hand tubes (Fig. 7/3)
Carpet and floor brush (Fig. 7/4)
Suction hose (Fig. 7/5)
Dusting brush (enclosed)
Crevice tool (enclosed)
Floor brush with rubber strip (enclosed)

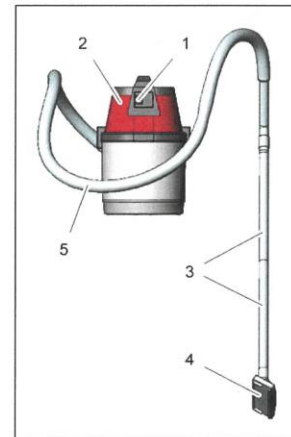

Fig. 7 Vacuum cleaner operation

EC Declaration of Conformity (in accordance with EC Directive 2006/42/EC)

Hako GmbH
Hamburger Straße 209-239
D-23843 Bad Oldesloe

declares in sole responsibility
that the product

Cleanserv VL140 L/24V
Type: 6509

to which this declaration relates, conforms with the relevant provisions of the safety and health requirements stipulated in EU Directive 2006/42/EC and is in accordance with 2014/30/EEC.

Reference was made to the following standards and/or norms and/or technical specifications to ensure proper implementation of the safety and health requirements in the EU Directives:

DIN EN 60335-2-69
DIN EN 60335-1

Bad Oldesloe, 23.01.2018

Ricardo Ruiz Porath
Produktlinienleiter -
Reinigungstechnik

Name of the authorized person who
compiles the technical documents for
Hako:

Ludger Lüttel